

# Ontario Line Subway Project Updates

## Pape Station and Sammon Crossover Advanced Works Construction Traffic and Transportation Impacts

### Ward 14 Toronto-Danforth

Transit Infrastructure Projects

Transportation Services

March 5, 2024



# Agenda

Ontario Line Overview

Pape Station Works

Sammon Crossover Works

Traffic Impact Mitigation Measures

Next Steps

Questions & Answers

# Ontario Line Overview: Area Context

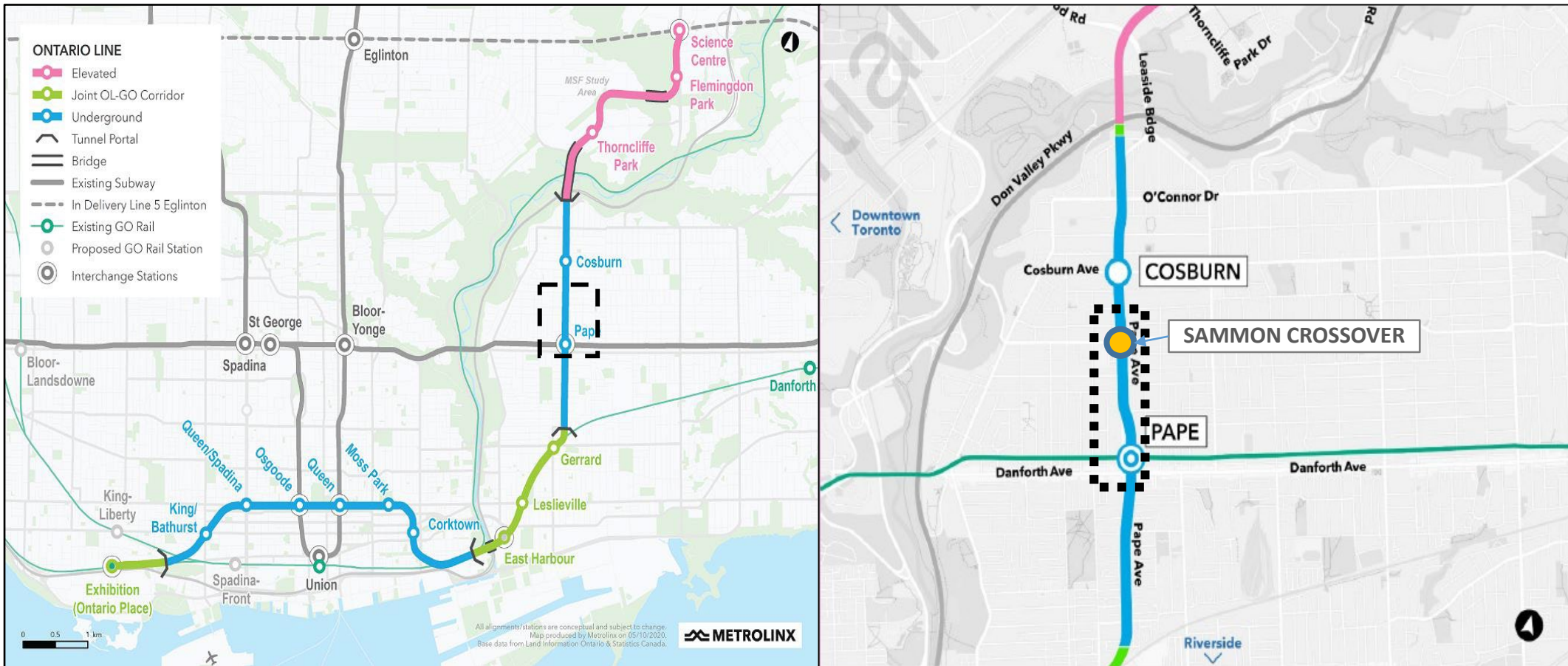

# Pape Station Works | Overview

## Pape Station Advanced Works (Q1 2024 – Q1 2025)

- I. TTC Pape Station Building Modification
- II. New Tunnel Ventilation Shaft Installation for OL
- III. Utility Relocation in the TTC bus loop and Lipton Ave

## Pape Station Support of Excavation\* Works (Q4 2023 – Q3 2026)

- I. Utility Relocation at Danforth Ave and Gertrude Pl
- II. Property Demolition
- III. Danforth SOE Construction
- IV. Gertrude SOE Construction

\*Support of Excavation (SOE) system to maintain stability and safety of deep excavations

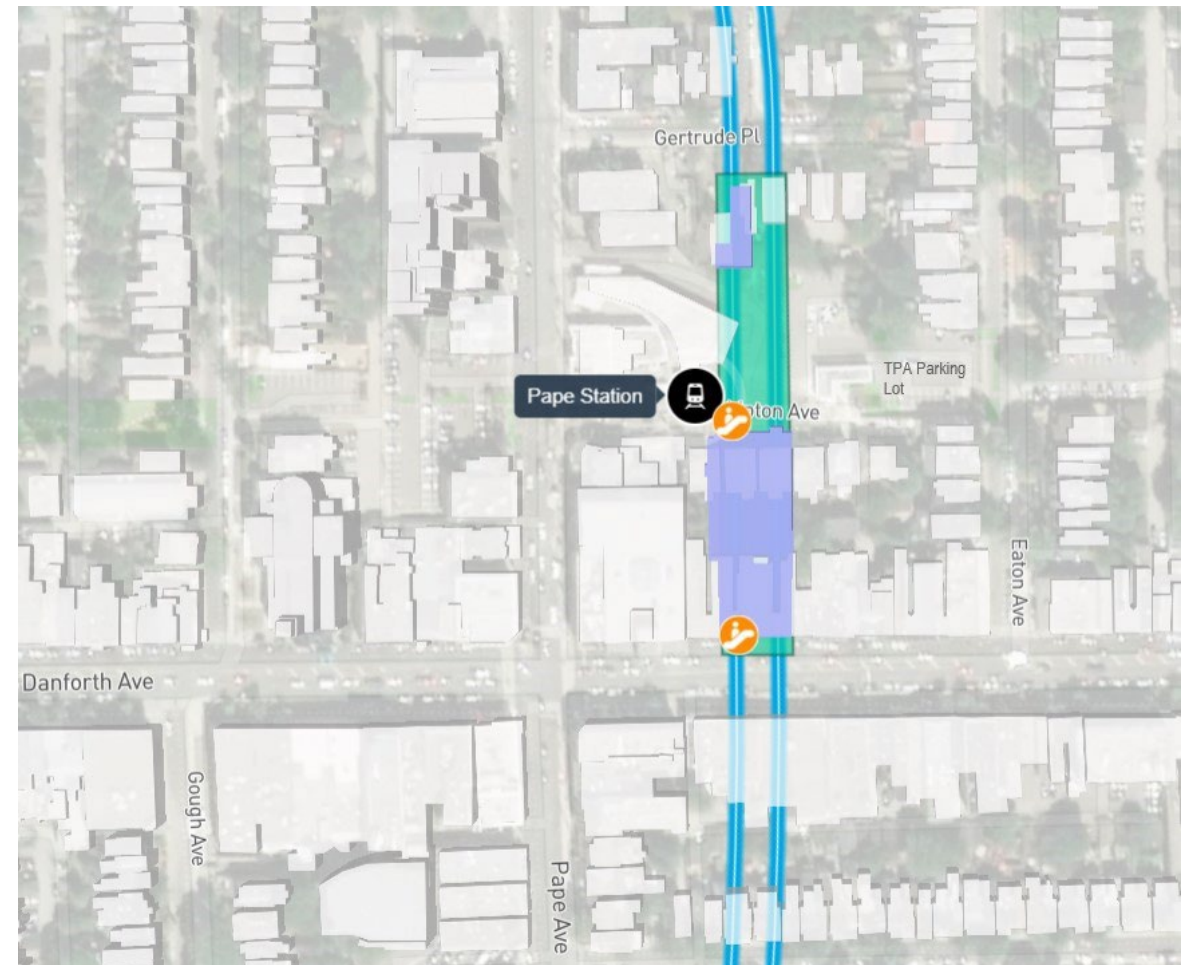

# Metrolinx's Construction Timeline

## Pape Station Advanced Works

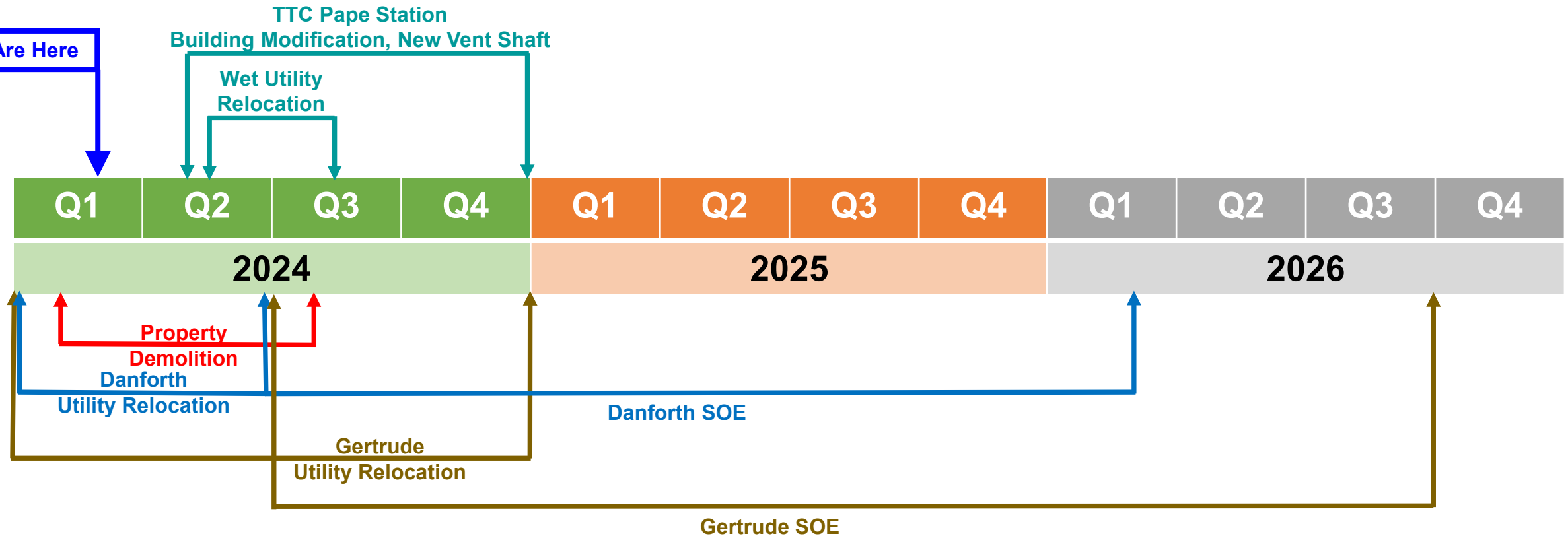

## Pape Station

## Support of Excavation Works



Notes: The timeline and phasing sequences are subjected to change based on Contractor's schedule



# Pape Station Advanced Works

(Q2 2024 – Q1 2025): Duration 8 months

## Traffic Impact:

- Lipton Ave will be fully closed to private vehicular traffic
- TTC buses will continue to use Lipton Ave as exit from bus loop
- Construction vehicles will be using Lipton Ave to access the site

## Pedestrian impact:

- Pedestrian Access to Pape Station will be maintained

## Parking Impact:

- On-street parking on Lipton Ave and Pape Ave will be temporarily removed
- TPA parking east of the Pape Station will be temporarily closed

## Transit Impact

- Subway service will generally be maintained except for planned weekend closure (details to follow)
- Pape Station bus loop will be temporarily closed for up to 5 months for utility relocation.
- Temporary bus stops will be accommodated on Pape Ave during the bus loop closure

## Business/Property Access

- Access to businesses and remaining properties on Lipton Ave will be maintained

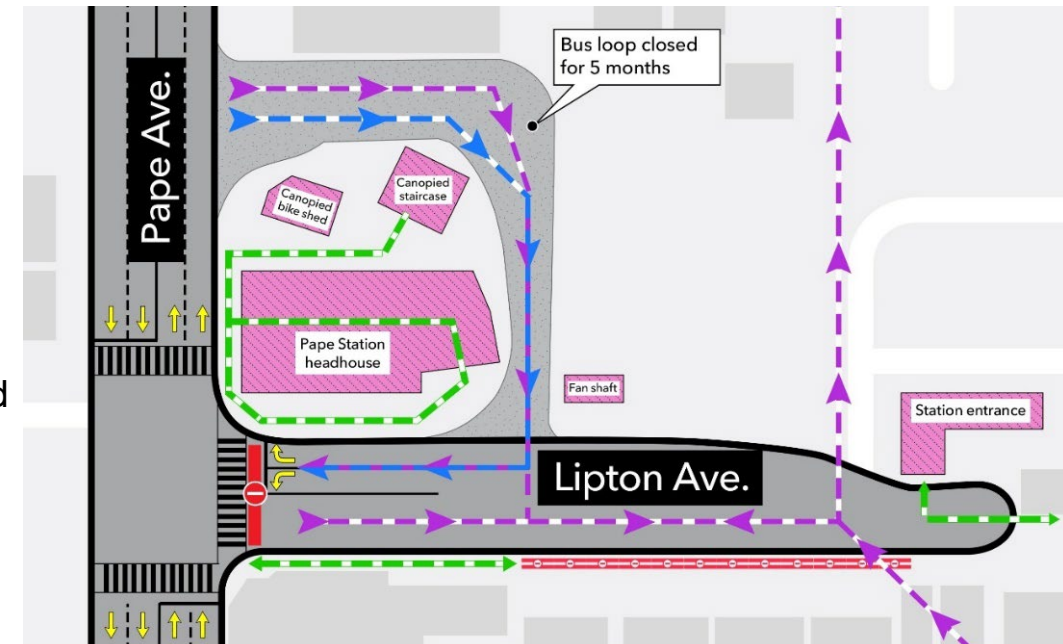

## Traffic Impacts During Pape Station Headhouse Modifications

Expected duration: 8 months

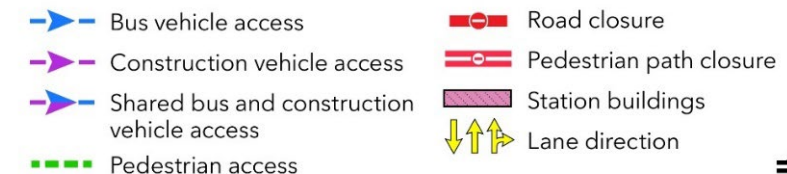

Note: Utility relocations and other works will necessitate four full weekend closures of the Pape subway station along Line 2 for 2 months.

# Pape Station SOE Works

## Utility Relocations – Danforth Avenue

(Q4 2023 – Q2 2024): Duration 6 months

### Dry Utility Relocation (Bell, Rogers, and Enbridge)

- Duration/Timeline: On-going works till May 2024
- Self-performed by Utility Company

### Traffic Impact:

- At least one lane per direction will be maintained along Danforth

### Cycling Impact:

- City staff will review the feasibility to maintain the bicycle lanes

### Parking Impact:

- On-street parking on Danforth (north side at the work zone) will be temporarily removed for up to 5 days.
- On-street parking on Eaton Ave (2-3 spaces)

### Pedestrian Impact:

- Sidewalk will be maintained

### Transit Impact

- No impact

### Business Access

- Access to businesses will be maintained

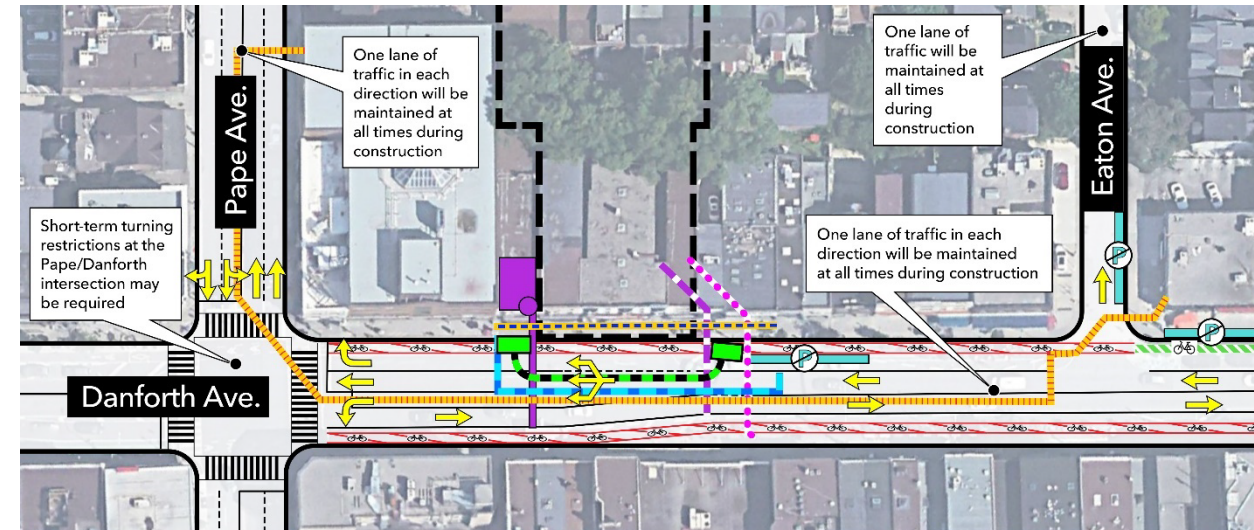

### Danforth Avenue Utility Relocation

Expected duration: 6 months

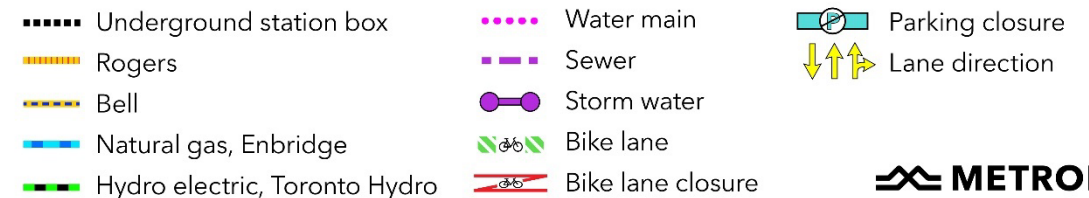

METROLINX

# Pape Station SOE Works

## Utility Relocations – Gertrude Place

Q1 2024 – Q4 2024): Duration 1 year

### Wet Utility Relocation

- Storm and sanitary sewers relocation

### Pedestrian Impact:

- South sidewalk on Gertrude Pl will be closed

### Traffic Impact:

- Temporary closure of traffic lane
- At least one lane will be maintained

### Parking Impact:

- Permit parking on the north side of Gertrude Pl will be temporarily removed

### Transit Impact

- No impact

### Business/Property Access

- Access to businesses and properties will be maintained

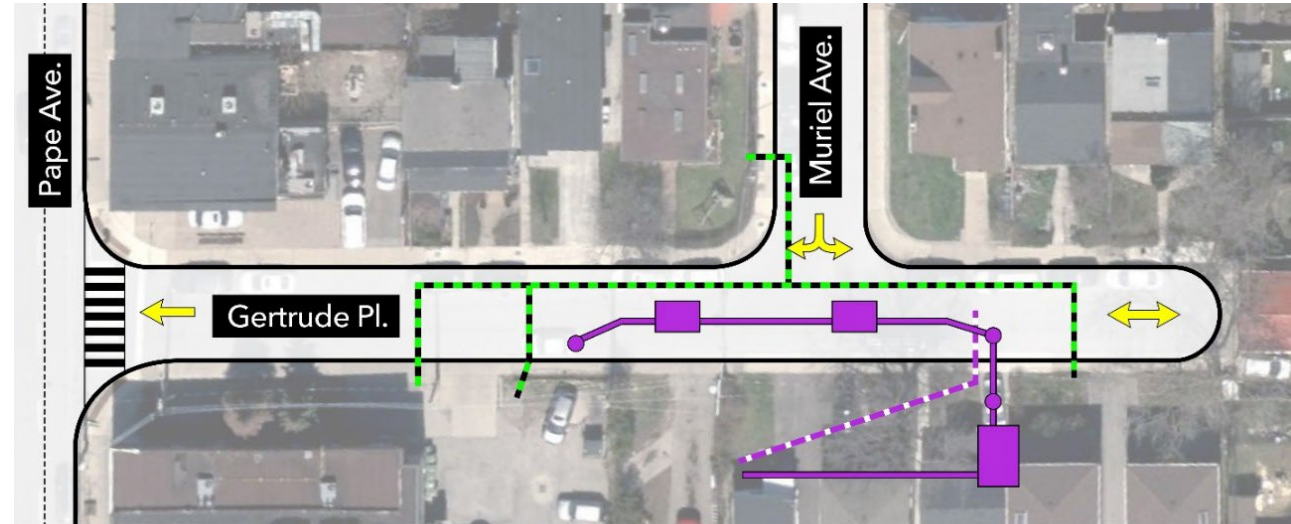

### Gertrude Place Utility Relocation

Expected duration: 1 year

- Hydro electric, Toronto Hydro
- - - Sewer
- Storm water
- ↕ Lane Direction

Note: Traffic lanes on Muriel Avenue and Gertrude Place will be maintained throughout utility relocations.

Relocations for telecommunication (Rogers, Bell) and natural gas utilities (Enbridge) were completed in 2023.

 METROLINX



# Pape Station SOE Works

## Property Demolition

(Q1 2024 – Q2 2024): Duration 6 months

### Traffic Impact:

- Lipton Ave will be fully closed to private vehicular traffic
- TTC buses will continue to use Lipton as exit from bus loop
- Construction vehicles will enter the site from Eaton Ave/Danforth Ave to access the site, and exit through Lipton Ave/Gertrude Pl

### Cycling Impact:

- Bike lanes on Danforth will be maintained

### Pedestrian impact:

- Pedestrian connectivity on Danforth will be maintained

### Parking Impact:

- On-street parking on Danforth will be temporarily removed (2-3 spaces)
- Permit parking on Eaton will be temporarily removed (2 spaces)
- All on-street parking on Lipton will be temporarily removed
- TPA parking lot east of Pape Station will be temporarily closed

### Transit Impact

- No impact

### Business/Property Access

- Access to businesses and remaining properties on Lipton Ave, Eaton Ave, and Danforth Ave will be maintained



**Note: The timeline and closure details are subjected to change based on Contractor's schedule.**

# Pape Station SOE Works: Danforth SOE Construction

(Q2 2024 – Q1 2026): Duration 1 year and 9 months

## Traffic Impact:

- One lane per direction will be maintained on Danforth Ave
- WBL movement will be restricted at Pape and Danforth intersection
- Pape Laneway South of Danforth will be closed during Phase 1

## Parking Impact:

- On-street parking on Danforth between Pape and Eaton will be temporarily removed
- Permit parking on Eaton Ave will be temporarily removed (2 spaces)

## Cyclist impact:

- Bike lanes will be maintained where feasible

## Pedestrian impact:

- Pedestrian connectivity on Danforth Ave will be maintained

## Transit Impact

- No impact

## Business Access

- Access to businesses will be maintained
- City staff are currently reviewing the feasibility to maintain CafeTO on the south side of Danforth Ave

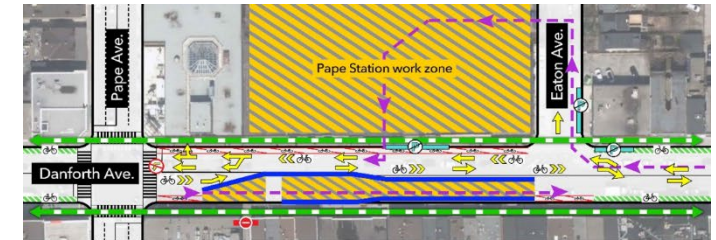

**Danforth Avenue Excavation Support  
Traffic Impacts  
Phase 1**

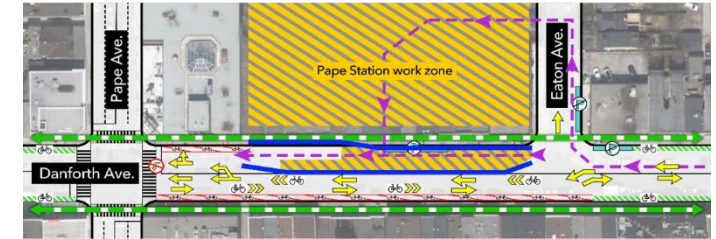

**Danforth Avenue Excavation Support  
Traffic Impacts  
Phase 2**

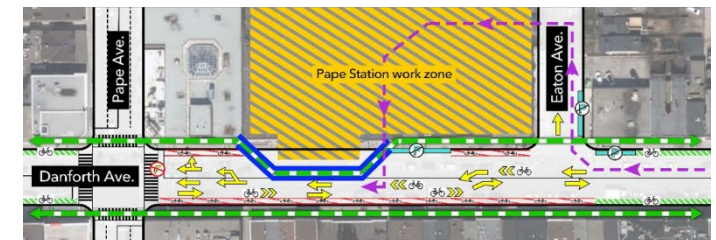

**Danforth Avenue Excavation Support  
Traffic Impacts  
Phase 3**



Note: Cyclists will merge into mixed traffic and share lanes with motorists along Danforth Avenue between Pape Avenue and Eaton Avenue.  
Note: Street-side parking on Danforth Avenue prohibited between Pape Avenue and Eaton Avenue.  
Note: Existing TTC bus stop locations at the intersection of Danforth Avenue and Pape Avenue will be maintained.  
Note: Road signage at the southeast corner of the Danforth/Pape intersection and at the northeast corner of the Danforth/Eaton intersection will inform motorists and cyclists of the shared bike/auto lane on Danforth Avenue between Pape Avenue and Eaton Avenue.



**Note: The timeline and closure details are subjected to change based on Contractor's schedule.**

# Pape Station SOE Works

## Gertrude SOE Construction

(Q2 2024 – Q3 2026): Duration 2 years and 3 months

### Traffic Impact:

- Traffic lane will be realigned but all movements will be maintained
- All property accesses will be maintained

### Pedestrian impact:

- At least one sidewalk will be maintained for the duration of the work.
- Temporary sidewalk will be provided when sidewalk is closed.

### Parking Impact:

- Permit parking on Muriel Ave and Gertrude Pl will be temporarily removed (Up to 12 spaces)

### Transit Impact

- No impact

### Business and Property Impact

- Access to Businesses and Properties will be maintained

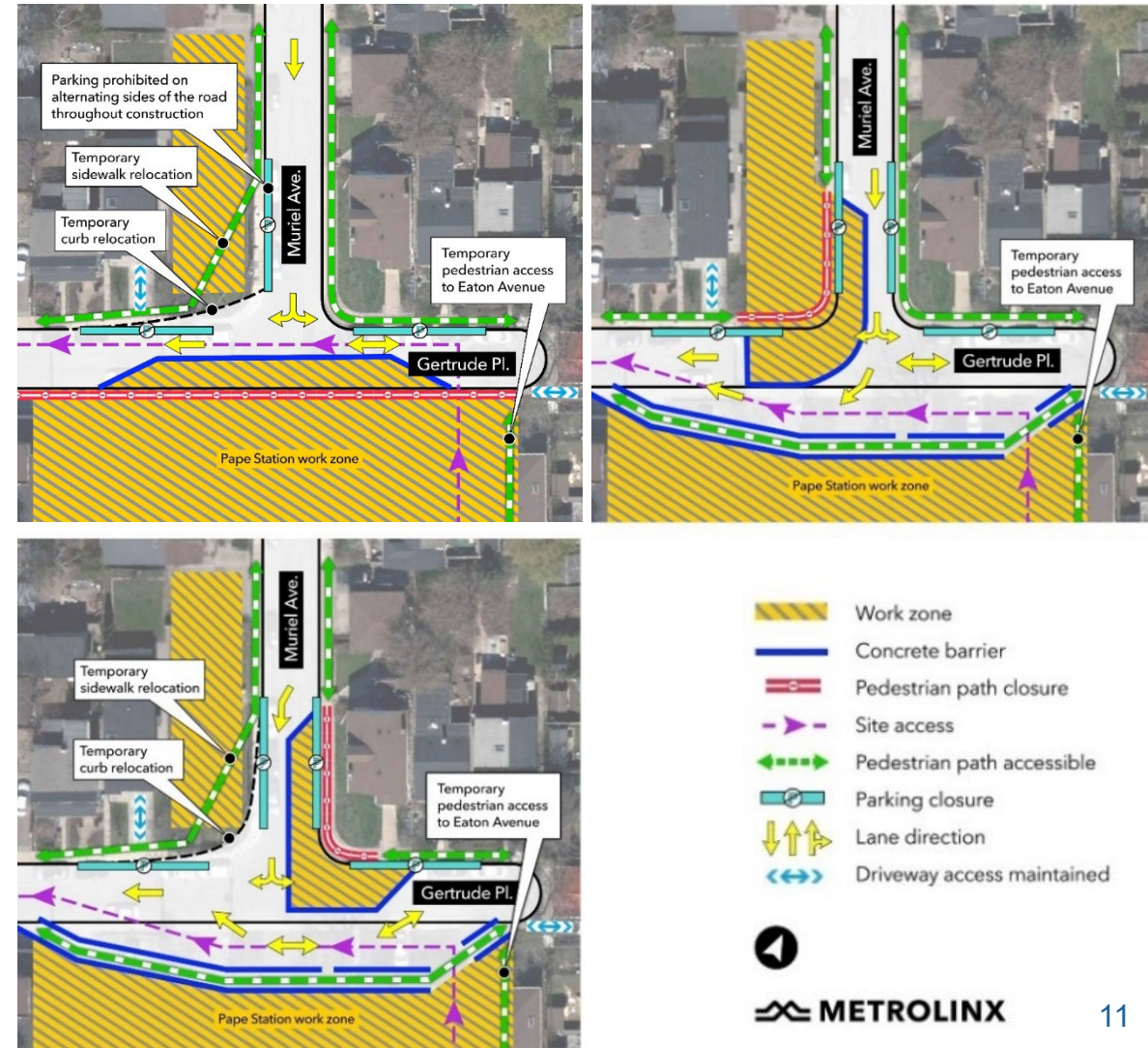



# Pape Station Overall Works

## Combined Traffic Impacts

(Q4 2023 – Q3 2026): Duration 3 years

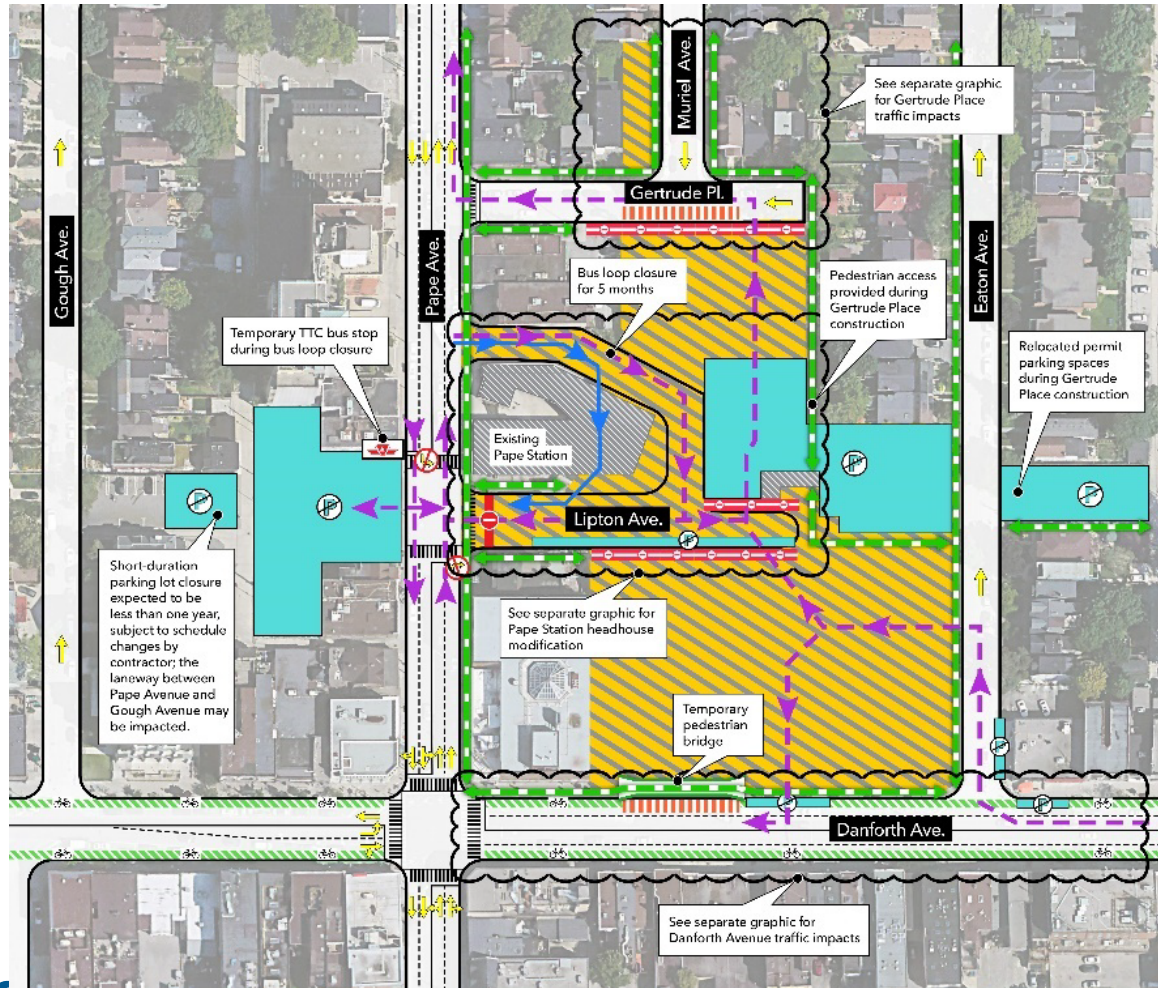

## Pape Station Advanced Works and Excavation Support Traffic Impacts

Expected duration: 3 years

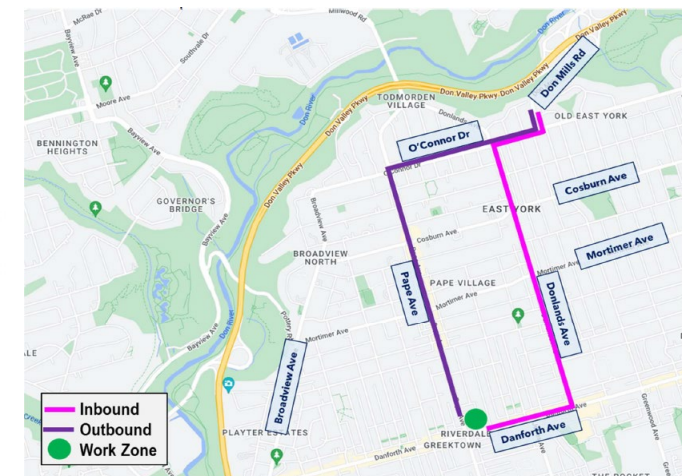
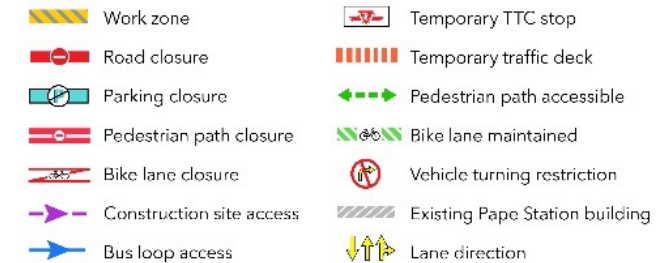



100%

- **Emergency Exit Building** will be constructed at the site



# Sammon Crossover Construction Impacts

(Q1 2024 – Q3 2027): Duration 3 years and 8 months

## Traffic Impact:

- Pape Ave will be temporarily reduced to one lane per direction between Kings Park Blvd and Browning Ave
- Potential left turning restrictions will be required between Macphail Ave and Browning Ave

## Pedestrian impact:

- South sidewalk on Sammon Ave between Pape Ave and the laneway will be temporarily closed
- East sidewalk on Pape Ave will be realigned to the roadway in front of the site

## Parking Impact:

- On-street parking on Pape Ave between Kings Park Blvd and Canning Ave will be removed
- Permit parking on Sammon Ave will be removed (3 spaces)

## Transit Impact

- TTC bus stops will be relocated north of Kings Park Blvd and south of Browning Ave.

## Business Access

- Access to businesses will be maintained

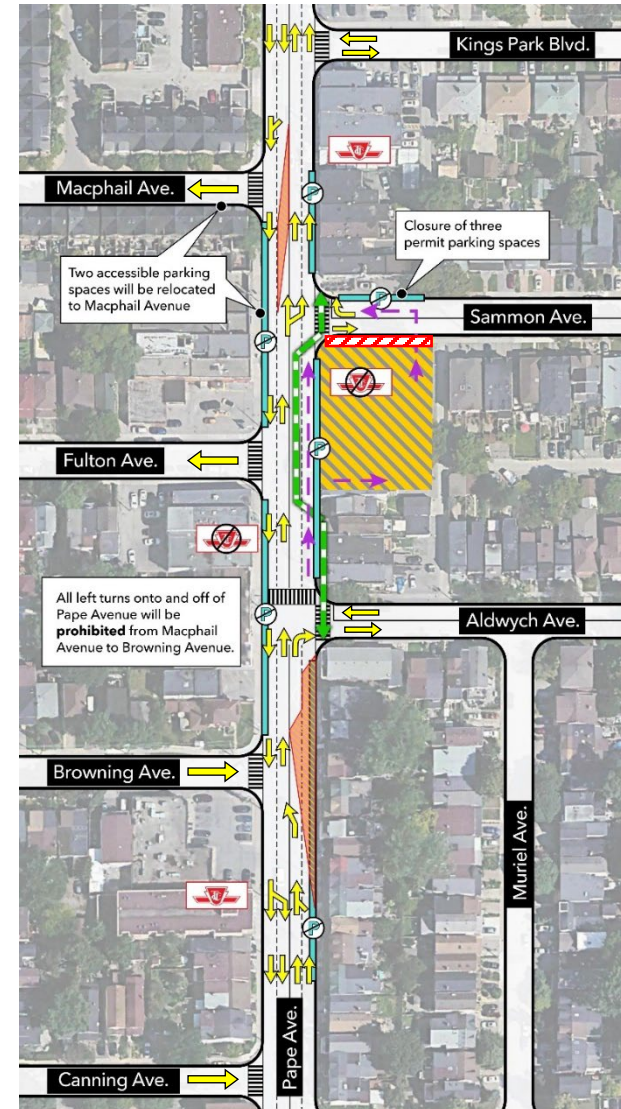

## Sammon Avenue Emergency Exit Building Construction Traffic Impacts

Expected duration: 3 years 8 months

- Work zone
- Temporary pedestrian path
- Parking closure
- TTC stop temporary closure
- TTC stop temporary relocation
- Lane merging and direction
- Site driveways and truck haul routes
- Sidewalk Closure

Note: On-street permit parking along Pape Avenue will be relocated, moving north to Mortimer Street.

Note: HOV lanes will be removed between Kings Park Boulevard and Canning Avenue for the duration of construction on the Sammon Avenue emergency exit building.



**METROLINX**



# City of Toronto Requirements

# Construction Impact Mitigation and Safety Measures

Metrolinx's contractor to **obtain permits** for work within the City road right-of-way.

- ✓ **Traffic Control Plan** will be reviewed by City staff to ensure that traffic, safety, emergency access, street event coordination issues are addressed.
- ✓ Traffic calming measures to **discourage neighbourhood traffic infiltration and speeding**
- ✓ **Watch Your Speed** monitoring system will be installed
- ✓ **Pedestrian wayfinding signage** will be installed
- ✓ Keep the cycle lane closure duration to the absolute minimum and Sharrow markings will be added to **enhance safety of the cyclists.**
- ✓ **Transit passengers' safety and accessibility** will be maintained at all times.
- ✓ Assess on-street and permit parking impacts and **review parking replacement**
- ✓ **Paid Duty Officer and/or Traffic Control Person(s)** will be on-site managing traffic and pedestrian flow.
- ✓ Metrolinx and their contractor to install **advanced advisory signage (PVMS).**
- ✓ Permit conditions will include provisions of sufficient lighting, restrictions of work hours for noise control, etc.



**VISIONZERO**





# Next Steps

- The City will coordinate with Metrolinx and their Contractor to ensure the work zone and traffic setup be compliance with City requirements from operations and safety perspectives
- Monitor the work zone and traffic configurations for the duration of the works and ensure safety for everyone in the community
- Participate in Traffic Management Committee (with representatives from the City, TTC, Mx and the contractor) to provide technical input on traffic related matters
- Request Metrolinx provide project updates and information through project website, traditional and electronic media
- On-going discussions with the local councillor, the businesses and the community
- Participate and coordinate with Metrolinx at Construction Liaison Committee (CLC) for issues and concerns raised by the community
- Ensure area-wide capital works coordination to minimize concurrent work on parallel routes and maximize traffic mobility and safety

# City of Toronto Contacts

**Navi Tathgar**, Manager

Transit Infrastructure Projects, Transportation Services

Tel: 416-397-4588

Email: [Navi.Tathgar@toronto.ca](mailto:Navi.Tathgar@toronto.ca)

**Astro Man**, Senior Engineer

Transit Infrastructure Projects, Transportation Services

Tel: 416-338-2046

Email: [Astro.Man@toronto.ca](mailto:Astro.Man@toronto.ca)

**Terry Francoeur**, Senior Project Manager

Transit Infrastructure Projects, Transportation Services

Tel: 416-338-5396

Email: [Terry.Francoeur@toronto.ca](mailto:Terry.Francoeur@toronto.ca)

